

FASTENING SYSTEM

Hidral Gobel distributes **UNWIN systems** for wheelchair fastening systems, belts for passengers with reduced mobility, as well as combined elements for wheelchairs and passengers. In addition, we also have seat fixings and technical floors for M1 and M2 vehicles.

WHEELCHAIR ANCHORAGE



4 POINTS ANCHORAGE Ref. 9519

- The anchorage system with adjustable front and rear straps.
- The 4-point anchorage system is a simple but effective method of securing the seat during transport.
- The 2 rear straps are fully adjustable thanks to a simple mechanism that allows the straps to be tightened for added security.
- The front anchorages are equipped with a buckle fastening for ease of use.
- The rear anchorages are equipped with a carabiner clasp.
- They are tested to withstand forces of 120 kg each.
- They can be installed on M1 as well as M2 and M3.



WHEELCHAIR ANCHORAGE



4 POINTS ANCHORAGE SYSTEM WITH QUATTRO SYSTEM Ref. 9532

- A retractable system with automatic tensioning mechanism for securing wheelchairs.
- The wheelchair restraint system incorporates a tensioner on the left and right hand side of the reel to easily secure the wheelchair during transport.
- They can be installed on M1 as well as M2 and M3.
- All QUATTRO systems have been dynamically tested to hold a wheelchair up to 120 kg, and therefore increasingly compatible with a wider range of wheelchair designs.
- Possibility to purchase only the QUATTRO system rear restraint (Ref. No. 9532/1).



WHEELCHAIR ANCHORAGE



ELECTRIC ANCHORAGE Ref. 9556

- The electrically adjustable strap anchorage system. To be found placed at the rear.
- Simple but effective method of securing the seat during transport. during transport.
- The two straps are fully adjustable. The belts are easily tensioned electrically by pressing a button on the casing.
- Can be combined with front anchorages.
- Available in 3 m and 4 m versions.
- The anchorages are equipped with carabiners for easy attachment.
- They are tested to withstand forces of 120 kg each.
- They can be installed in M1 as well as M2 and M3.

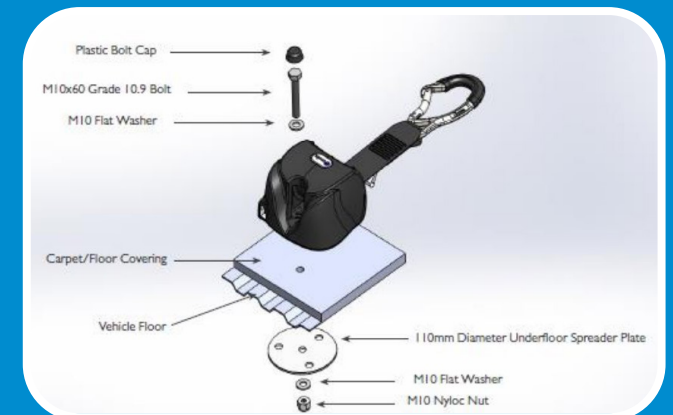

PASSENGER FASTENING



2 POINTS SAFETY BELTS Ref. 9506

- The casing consists of two spools, the black one is for the ventral attachment (around the belly) and the red reel is for the third point shoulder attachment option.
- The reels have a safety brake system.
- The two-point lap belt is for M2 and M3.



PASSENGER FASTENING



THIRD POINT ATTACHMENT Ref. 9507

- Belt that hooks onto a RAIL section installed on the top of the vehicle window above the vehicle window frame and anchors with a male buckle located on the belt reel.
- The 3-point belt is for M1.



COMBINED SYSTEM



WHEELCHAIR AND PASSENGER Ref. 9520

- This 4-point anchorage system to the rails combines the webbing attachment to secure the chair with the reel belt kit and the half shank.
- The two rear straps are fully adjustable thanks to a simple mechanism that allows the webbing to be tightened for added security.
- The front anchorages are equipped with a buckle fastening for ease of use.
- The rear anchorages are equipped with a carabiner clasp.
- They are tested to withstand forces of 120 kg each.
- They can be installed on M1 as well as M2 and M3.
- The housing consists of two reels, the black reel is for the ventral attachment (around the belly) and the red reel is for the third point attachment option on the shoulder.
- The reels have a safety brake system.
- Possibility to purchase only the rear attachment (9520/1).



FIXATIONS OF REMOVABLE SEAT



This new seat installation allows any seat to be easily fitted or removed from the vehicle with either surface or recessed mounting rails. These removable seat mountings are available in three different types:

STANDARD SL SEAT FIXATION Ref. 9511

- The plunger mechanism allows the seat to be quickly locked in place.
- The removable seat bracket is equipped with 3 screws for a more secure fixation.



FIXATIONS OF REMOVABLE SEAT



HAL SEAT FIXATION Ref. 9524/1

- Easy to use with one hand, it has a joystick activated clamping system.
- The HAL seat mount is equipped with a bolt that runs to secure it to the legs of the seat.



ULS SEAT FIXATION Ref. 9555

- To fix it, press it with the foot and to release it, lift up the clamp system.
- The ULS seat fastening is equipped with a screw that runs to secure it to the seat legs.



FIXATION RAILS



LOW PROFILE RAILS Ref. 9512

- Low profile rails are embedded into the floor of the vehicle giving a clean finish.
- They protrude from the floor by only 3.5mm.
- They require M8 or M6 screws, fixed into countersunk holes at 101.6 mm intervals with the screw heads flush.
- 37 screws are required per 3.66 m slide.
- Low profile rails can be cut to size on request.
- These rails are available in three types: drilled M6 and M8 and non-drilled.



FIXATION RAILS



SURFACE RAILS

Ref. 9510

- The mounting of the surface rails is simple and quick and adaptable to vehicle floors.
- They protrude from the floor by only 13.5 mm.
- They require M8 or M6 screws, fixed in the countersunk holes at 101.6 mm intervals with flush screw heads.
- 37 screws are required per 3.66 m runner.
- Low profile rails can be cut to size on request.



FIXATION RAILS



OTHER ACCESORIES Ref. 9513

- Low profile rail terminal (Ref. No. 9513).
- Surface-mounted rail terminal (Ref. No. 9514).
- Rail cover 25 m (Ref. No. 9523/2).



Hidral  Gobel



+34 91 677 00 95
hidralgobel.com
info@hidralgobel.com
linkedin.com/hidral-gobel
