

# FASTENING SYSTEM

Hidral Gobel distributes **UNWIN systems** for wheelchair fastening systems, belts for passengers with reduced mobility, as well as combined elements for wheelchairs and passengers. In addition, we also have seat fixings and technical floors for M1 and M2 vehicles.

# WHEELCHAIR ANCHORAGE



## 4 POINTS ANCHORAGE Ref. 9519

- The anchorage system with adjustable front and rear straps.
- The 4-point anchorage system is a simple but effective method of securing the seat during transport.
- The 2 rear straps are fully adjustable thanks to a simple mechanism that allows the straps to be tightened for added security.
- The front anchorages are equipped with a buckle fastening for ease of use.
- The rear anchorages are equipped with a carabiner clasp.
- They are tested to withstand forces of 120 kg each.
- They can be installed on M1 as well as M2 and M3.



# WHEELCHAIR ANCHORAGE



## 4 POINTS ANCHORAGE SYSTEM WITH QUATTRO SYSTEM Ref. 9532

- A retractable system with automatic tensioning mechanism for securing wheelchairs.
- The wheelchair restraint system incorporates a tensioner on the left and right hand side of the reel to easily secure the wheelchair during transport.
- They can be installed on M1 as well as M2 and M3.
- All QUATTRO systems have been dynamically tested to hold a wheelchair up to 120 kg, and therefore increasingly compatible with a wider range of wheelchair designs.
- Possibility to purchase only the QUATTRO system rear restraint (Ref. No. 9532/1).



# WHEELCHAIR ANCHORAGE



## ELECTRIC ANCHORAGE Ref. 9556

- The electrically adjustable strap anchorage system. To be found placed at the rear.
- Simple but effective method of securing the seat during transport. during transport.
- The two straps are fully adjustable. The belts are easily tensioned electrically by pressing a button on the casing.
- Can be combined with front anchorages.
- Available in 3 m and 4 m versions.
- The anchorages are equipped with carabiners for easy attachment.
- They are tested to withstand forces of 120 kg each.
- They can be installed in M1 as well as M2 and M3.

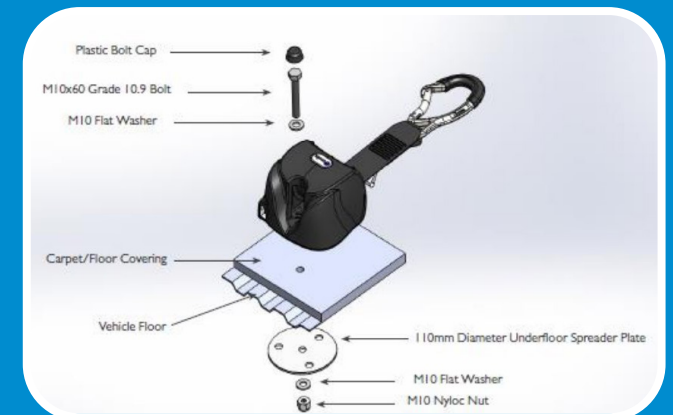

# COMBINED SYSTEM



## WHEELCHAIR AND PASSENGER Ref. 9520

- This 4-point anchorage system to the rails combines the webbing attachment to secure the chair with the reel belt kit and the half shank.
- The two rear straps are fully adjustable thanks to a simple mechanism that allows the webbing to be tightened for added security.
- The front anchorages are equipped with a buckle fastening for ease of use.
- The rear anchorages are equipped with a carabiner clasp.
- They are tested to withstand forces of 120 kg each.
- They can be installed on M1 as well as M2 and M3.
- The housing consists of two reels, the black reel is for the ventral attachment (around the belly) and the red reel is for the third point attachment option on the shoulder.
- The reels have a safety brake system.
- Possibility to purchase only the rear attachment (9520/1).



Hidral  Gobel



+34 91 677 00 95  
[hidralgobel.com](http://hidralgobel.com)  
[info@hidralgobel.com](mailto:info@hidralgobel.com)  
[linkedin.com/hidral-gobel](https://linkedin.com/hidral-gobel)

---